

TX^{PRO}

Crossflow Truck Paint Booth

TX^{PRO}



STANDARD FEATURES

- 18 Gauge Steel Construction Panels
- Wall Mounted & Gable Lighting
- Prefilter, Ceiling Filter, Exhaust Filter Included
- 1 Personnel Door with Tempered Glass
- Non-Sparking Tube Axial Exhaust Fan with 3 Phase Motor (Single Phase Optional)

accudraft

I N D U S T R I A L

SAIMA of North America Inc.

Randolph, New Jersey 07869 | (800) 524-0340

info@accudraftpaintbooths.com | www.accudraftpaintbooths.com

TX^{PRO}

Crossflow Paint Booth

TX^{PRO}

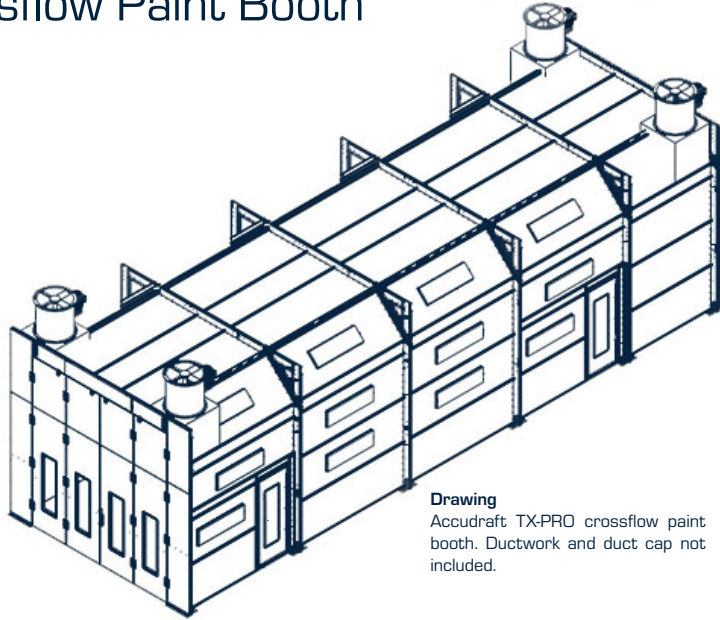

Drawing

Accudraft TX-PRO crossflow paint booth. Ductwork and duct cap not included.

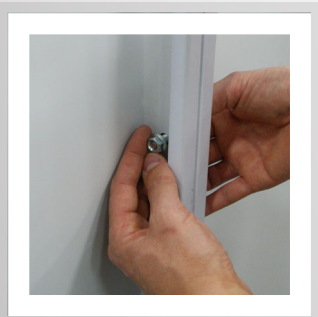

NOT INCLUDED: Controls, VFDs, Wiring Supplies, Caulk or Duct Work

Models: 16' wide x 16' high 28,000 CFM / (2) 5 HP / (2) 30" Fans

TXCD301616	Standard Dimensions: 30' l x 16'w x 16'h Interior Dimensions
TXCD401616	Standard Dimensions: 40' l x 16'w x 16'h Interior Dimensions
TXCD501616	Standard Dimensions: 50' l x 16'w x 16'h Interior Dimensions
TXCD601616	Standard Dimensions: 60' l x 16'w x 16'h Interior Dimensions
TXCD701616	Standard Dimensions: 70' l x 16'w x 16'h Interior Dimensions
TXCD801616	Standard Dimensions: 80' l x 16'w x 16'h Interior Dimensions
TXCD301816	Standard Dimensions: 30' l x 18'w x 16'h Interior Dimensions
TXCD401816	Standard Dimensions: 40' l x 18'w x 16'h Interior Dimensions
TXCD501816	Standard Dimensions: 50' l x 18'w x 16'h Interior Dimensions
TXCD601816	Standard Dimensions: 60' l x 18'w x 16'h Interior Dimensions
TXCD701816	Standard Dimensions: 70' l x 18'w x 16'h Interior Dimensions
TXCD801816	Standard Dimensions: 80' l x 18'w x 16'h Interior Dimensions
TXCD302016	Standard Dimensions: 30' l x 20'w x 16'h Interior Dimensions
TXCD402016	Standard Dimensions: 40' l x 20'w x 16'h Interior Dimensions
TXCD502016	Standard Dimensions: 50' l x 20'w x 16'h Interior Dimensions
TXCD602016	Standard Dimensions: 60' l x 20'w x 16'h Interior Dimensions
TXCD702016	Standard Dimensions: 70' l x 20'w x 16'h Interior Dimensions
TXCD802016	Standard Dimensions: 80' l x 20'w x 16'h Interior Dimensions

OPTIONS:

Doors BI FOLD DOORS - MAX SIZE 14' w x 16' h

VP-TXDT16	Drive Through Four Door Front - 12' w x 14' h Opening
VP-SD	Additional Service Door with Observation Window
VP-R016	Roll Up Option per Door Front for a 16' wide Booth
VP-R018	Roll Up Option per Door Front for a 18' wide Booth
VP-R020	Roll Up Option per Door Front for a 20' wide Booth

Optional Heating System:

P-SA28	PRO AMU - (2) 10 HP Motor / 28,000 CFM / 2.5 Mil BTU Direct Fired Burner Smart Pad Controls Included
P-SA32	PRO AMU - (2) 15 HP Motor / 32,000 CFM / 2.5 Mil BTU Direct Fired Burner Smart Pad Controls Included

Control Panel: CHOOSE ONE

90500	On/Off Control Panel for Non-Heated Booth Including Spray Gun Interlock (Potentiometer with VFD Upgrade Only)
-------	---

Optional VFDs

90274	Variable Frequency Drive - 5 HP - 230V
90275	Variable Frequency Drive - 5 HP - 460 V
90276	Variable Frequency Drive - 7.5 HP - 230V
90277	Variable Frequency Drive - 7.5 HP - 460 V
90278	Variable Frequency Drive - 10 HP - 230V
90279	Variable Frequency Drive - 10 HP - 460 V



MADE IN THE USA

accudraft

INDUSTRIAL

SAIMA of North America Inc. | Randolph, New Jersey 07869 | (800) 524-0340

info@accudraftpaintbooths.com | www.accudraftpaintbooths.com